

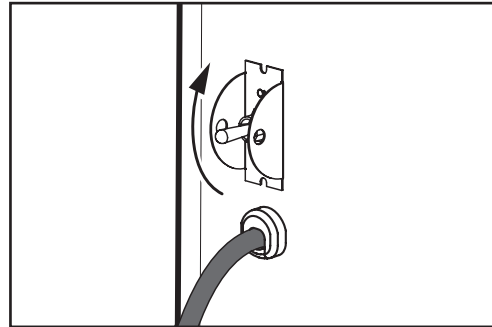

TLP Power Down Procedure

1 Turn the brewer OFF

To prepare the brewer for an extend period of non-operation, simply flip the toggle switch, at the back of the brewer, to the "OFF" position.



2 Turn the brewer ON

To re-engage the brewer, flip the toggle switch to the "ON" position.

Empty water from the hot water faucet. If the water is clear, continue to empty 5 gallons of water from the hot water faucet.

When the brewer is "Ready to Brew", brew 2 times to the Curtis recommended dispenser. Check that the water volumes are to the appropriate level.

! **IMPORTANT** - Replace the water filter if the brewer has been inactive for more than 30 days.

3 Check if the brewer is ready

If the brewer operates normally and the water is clear, brewer should be ready to use.

